



ENDRESS & HAUSER PRESSURE TRANSMITTERS

As distributors for Endress & Hauser, the world's largest private instrumentation company, PCI are able to offer a selection from their range of top quality pressure transmitters.

CERABAR S PMP731

The Cerabar S PMP 731 with polysilicon measuring cell is a universally-applicable, robust transmitter for measuring the process pressures of gases, vapours and liquids in all areas of chemical and process engineering.

With stainless steel flush-mounted diaphragm or internal diaphragm with adapter the PMP 731 provides excellent long-term stability and overload resistance up to 4 times nominal pressure (max. 600 bar/9000 psi).

With a full function-monitoring system, simple 4-button optimisation adjustment (without applying calibration pressure), turndown up to 100:1 and 100% full scale value adjustment range, the PMP 731 puts you in control of your process.



Feature	Standard	Option
Measuring Diaphragm	Flush-mounted	Threaded process adapter
Diaphragm Material	316L St. Steel	C276 Hastelloy
Housing	316L St. Steel	Epoxy-coated aluminium
Display	LCD	Blind (aluminium housing only)
Operating Temperature	-40 to + 85°C	
Ambient Temperature	-40 to + 100°C	
Communication Protocol	HART®	Profibus-PA, Foundation Fieldbus
Certification	EEx ia	EEx d
Power Supply	11.5 to 45V DC	
Process Connection	½" BSP	Others on request
Cable Entry	M20 x 1.5	½" NPT, ½" BSP
Output	4 - 20mA (2-wire)	
Inaccuracy	<0.1% of adjusted measuring range	
Min Range	5 mbar	

OPERATION

The process pressure deflects the separating diaphragm, with a filling liquid transmitting the pressure to a resistance bridge. The bridge output voltage, which is proportional to pressure, is then measured and processed.

INSTRUMENT LIMITATIONS

Pressure Reference	Operating Limits	Nominal value	Rec. min. span	Overload	Resistance to low pressure
	bar			bar	
gauge	-1...1	1*	0.05	4	10
gauge	-1...2.5	2.5	0.125	10	10
gauge	-1...10	10	0.5	40	10
gauge	-1...40	40**	2	160	10
gauge	-1...100	100**	5	400	10
gauge	-1...400	400**	20	600	10
absolute	0...1	1*	0.05	4	10
absolute	0...2.5	2.5	0.125	10	10
absolute	0...10	10	0.5	40	10
absolute	0...40	40	2	160	10
absolute	0...100	100	5	400	10
absolute	0...400	400	20	600	10

* Technical data for linearity and temperature effect are doubled.

** Absolute pressure sensors





ENDRESS & HAUSER PRESSURE TRANSMITTERS

PROCESS CONNECTION

The diaphragm is mounted flush to a 1/2" BSP thread and a sealing gasket is supplied. An optional adapter is available with a variety of external threads to internalise and protect the diaphragm.

External threads available are: 1/2" BSP M, 1/2" NPT M, 1/2" NPT F, M20 x 1.5. Others may be available on request.

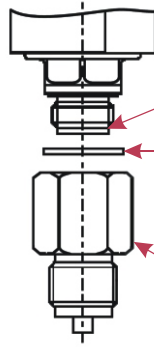

Process connection with flush-mounted diaphragm

Sealing Gasket

Optional threaded adapter for internalising and protecting diaphragm



The PMP 731 can be fitted to any of PCI's range of hygienic, chemical or flanged diaphragm seal systems, a selection of which are illustrated.



ORDERING MATRIX

Locate the order code for your specification and enter it into the appropriate box. See the pressure range codes page for further information.

PRESSURE RANGE		PRESSURE REFERENCE		HOUSING		COMMUNICATION PROTOCOL		CERTIFICATION	
B9	P9	1. Gauge		A: St. Steel 316L		A: HART®		A: None	
BB	PB	2: Absolute		B: Epoxy-coated		B: Profibus-PA		B: NACE MR0175 / 3.1.B	
BE	PE					C: Fieldbus			
BH	PH								
BJ	PJ								
BM	PM								

QUANTITY		PROCESS ADAPTER		DISPLAY		DIAPHRAGM MATERIAL		CABLE ENTRY		SAFETY		MOUNTING BRACKET	
		1. None		A: Standard		1: St. Steel 316L		1: M20 x 1.5		A: EEx ia		A: None	
		2: 1/2" BSP M		B: Blind *		2: Hastelloy C276		2: 1/2" NPT		B: EEx d		B: Wall	
		3: 1/2" NPT M						3: 1/2" BSP				C: Pipe	
		4: 1/2" NPT F											
		5: M20 x 1.5											

MODEL NO													
PMP	731												

--	--	--	--	--	--	--	--	--	--	--	--	--	--

Can be fitted with **DS** **FS**

Select the diaphragm seal system you want to have connected to this transmitter and write in the complete order number in the empty matrix above. Together with the transmitter order number this completes the specifications for your instrument.