

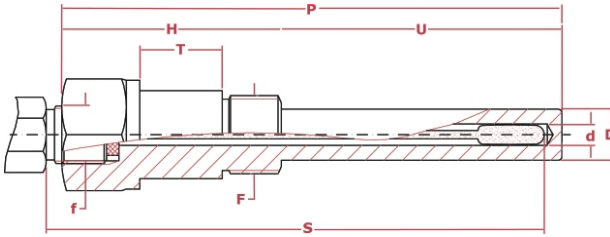

THERMOWELLS



Dimension	
d	inside diameter
D	outside diameter
U	insertion length
S	stem length thermometer
P	total length well
f	instrument connection
F	process connection
T	extension length
H	total connection length

LAGGING EXTENSIONS

Thermowells can be fitted with a lagging extension which allows the instrument to be easily removed without the need to remove any insulation lagging surrounding the tank or pipe containing the medium to be measured or for the connection head to be positioned away from the heat source.

PCI custom-made lagging extensions are welded onto the thermowell to provide high-quality pressure-resistant unions. Standard extensions are produced from 316 Stainless Steel although other materials are available.

Extension lengths must be specified according to your requirements. Instrument connections are BSP and NPT with sizes from 1/2" to 2".



FABRICATED THERMOWELLS

Fabricated thermowells or pockets are constructed from pipe, tube and bar and are essentially a welded composite of components.

They represent a cost-effective solution for low pressure, low velocity process situations.

Because pockets are produced from pipe, the only insertion profile available is the parallel (see introduction). The only tip option is flat, as shown.

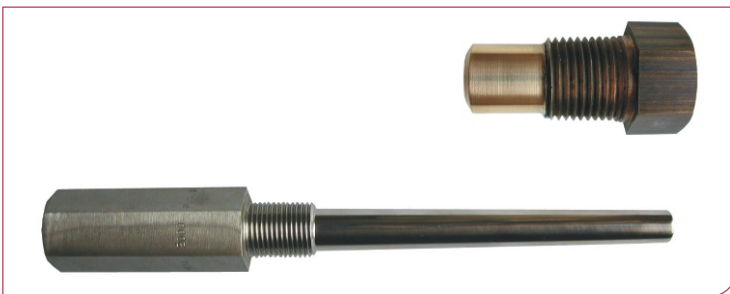



ORDERING MATRIX

Locate the order code for your specification and enter it into the appropriate box. See the previous pages for more information about each option.

FABRICATED THERMOWELL

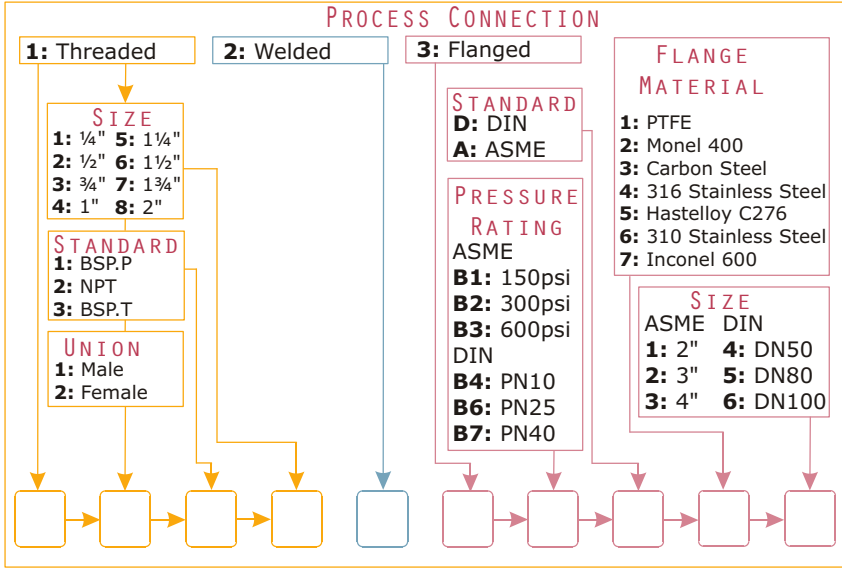

EXTERNAL DIAMETER
Specify mm or inch

INTERNAL DIAMETER
Specify mm or inch

QUANTITY

MODEL NO

TW 100

MATERIAL

1: PTFE
2: Monel 400
3: Carbon Steel
4: 316 Stainless Steel
5: Hastelloy C276
6: 310 Stainless Steel
7: Inconel 600
8: Recrystallised Alumina

IMMERSION LENGTH
Specify mm or inch

INSTRUMENT CONNECTION

SIZE

1: 1/4" **5:** 1 1/4"
2: 1/2" **6:** 1 1/2"
3: 3/4" **7:** 1 3/4"
4: 1" **8:** 2"

STANDARD

1: BSP.P
2: NPT
3: BSPT

UNION

1: Male
2: Female

LAGGING EXTENSION MATERIAL

1: PTFE
2: Monel 400
3: Carbon Steel
4: 316 Stainless Steel
5: Hastelloy C276
6: 310 Stainless Steel
7: Inconel 600
8: Recryst. Alumina

LENGTH
Customer specification

DIAMETER
Customer specification



Can be fitted to **TH** **PT**

When you have completed the specification of your thermowell above, copy it onto the specification for the instrument you wish it to be fitted to. The two specifications together complete the order for your instrument.