



# Express 100

## TEST PRESSURE GAUGE

**Model No.:** EP 100

With its high accuracy rating, mirror dial and full safety pattern specification, the **Express 100** provides a reliable alternative to deadweight testing for the precision calibration of pressure instrumentation.

A copper / beryllium Bourdon Tube option can improve accuracy even further.



Model	ø 160mm
EP 100 A	bottom entry
EP 100 D	eccentric back entry

### Standard Features:

Gauge Diameter	ø 160mm	ø 160mm
	EP 100 316	EP 100 CuBe
case with bayonet bezel	stainless steel	
bourdon tube system	stainless steel	copper beryllium
blow-out disk	NBR	
blow-out back	inc. baffle wall	
window	safety glass	
range in bar or equivalent	-1/0 .... 0/1000 bar	
thread bsp - npt - bspt	1/2"	
max. process temperature	60 °C	
accuracy at 20 °C	0.50%	0.25%
dial single scale	mirror	
pointer	micro-adjustable with counterweight and twisted tip	

OPTIONS	EP 100 316	EP 100 CuBe
front flange for panel mounting	*	*
carrying case	*	*
dual scale (non mirror)	*	X
dual scale (mirror)	X	*
accuracy 0.1%	X	X
accuracy 0.6%	*	X
lead seal	*	*

\* = option available  
 x = option unavailable  
 s = standard feature

www.pci-instruments.com..... +44 (0) 1704 509090 ..... sales@pci-instruments.com.....

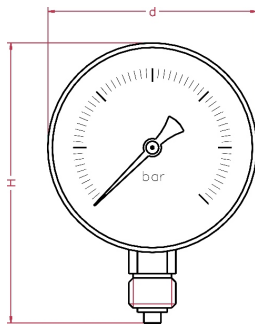

TYPE A

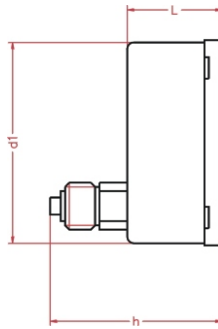

TYPE D - eccentric back

see section on connection positions for more details

Dimensions	EP 100 316	EP 100 CuBe
d in mm	160	160
d1 in mm	149	149
L in mm	64	55
H in mm	200	200
h in mm	107	89
weight in kg	1.2	1.1



## ORDERING MATRIX ~ EP100

Locate the order code for your specification and enter it into the appropriate box. See the above tables and the pressure codes reference section in the introduction for more details.

QUANTITY	BOURDON TUBE 1: St. Steel 316 2: Cu / Be	FRONT FLANGE N: No Y: Yes	CARRY CASE N: No Y: Yes	LEAD SEAL N: No Y: Yes
MODEL No. EP100A EP100D	PRESSURE RANGE B0 - B0 P0 - P0 R0 - R0 K0 - KD	PROCESS CONNECTION B: 1/2" BSP Male N: 1/2" NPT Male T: 1/2" BSP.T Male	MIRROR SCALE (dual scales only) N: No Y: Yes	CUSTOM LOGO N: no Y: yes
<input type="text"/>	<input type="text"/>	<input type="text"/>	<input type="text"/>	<input type="text"/>

Can be fitted with

DS

FS

If you want this gauge to be fitted with any of these process components, go to the relevant section of the catalogue and copy your gauge's order number onto the appropriate data sheet. Then simply add the specifications for your component.