

PCI's Hygeia range of hygienic or sanitary diaphragm seal systems are manufactured to the highest possible standard for use in all food process, pharmaceutical and chemical applications. 3-A approved and with in-house laser-welded diaphragms, they can be fitted to any pressure transmitter, switch or gauge.

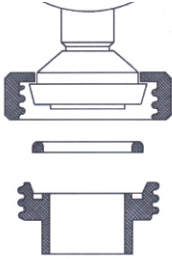

## DIN diaphragm seal system

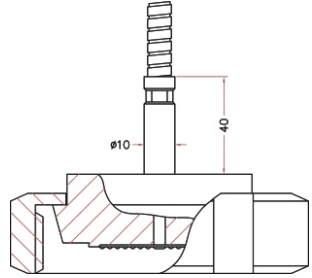

### Standard Features:

process connection	AISI-316 L
diaphragm material	AISI-316 L
diaphragm finish	high polish
transmission fluid	TO - 05 (FDA)



Process Standard / Connection Size	ASME	1"	1½"	2"	3"
	DIN	DN25	DN40	DN50	DN80
<b>Max. Process Pressure at 20 °C (bar)</b>		10	40	25	25
<b>Min. Span for GP &amp; AP (mbar)</b>		2000	2000	1250	200
<b>Min. Span for DP (mbar)</b>		-	-	300	20
<b>Min. Pressure Range for PI (bar)</b>		4	2.5	1.6	0.5
<b>Max. Capillary Length (metre)</b>		-	6	10	15
<b>Min./Max. Process Temperature (°C)</b>		-30 /+180	-30 /+180	-30 /+180	-30 /+180



OPTIONS	
<b>Transmission Fill</b>	TO - 01, TO - 02, TO - 03, TO - 05, TO - 11, TO - 17, TO - 23, TO - 31, TO - 41, TO - 47
<b>Capillary</b>	Seamless AISI-316 L,
<b>Armour</b>	Flexible stainless steel
<b>Certificates</b>	calibration test certificate, conformity certificate on pressurized parts (2.2), EN 10204 3.1.B material certificate, MR 01.75 NACE certificate

## Instrument Limitations

Process Connection DIN		Minimum Span (mbar)			Pressure Gauge Minimum Range (bar)		
		Transmitter Type			Gauge Diameter (mm)		
Connection Size	Diaphragm Diameter (mm)	GP	AP	DP	ø 63	ø 100	ø 160
1" / DN25	22	2000	2000	-	4	4	-
1½" DN40	32	2000	2000	-	2.5	2.5	-
2" / DN50	46	1250	1250	300	1.6	1.6	1.6
3" / DN80	72	200	200	20	0.5	0.5	0

### Effects of temperature on pressure readings per ±10 °C ( in mbar) ~ measured from 20°C

Process Connection: DIN		Transmitters					Gauges					
Connection Size	Diaphragm Diameter (mm)	GP	AP	DP	Seal	Capillary per metre	Pressure (bar)	Gauge Diameter			Seal	Capillary per metre
								ø 63	ø 100	ø 160		
1" DN25	22						<20	100	100		200	
1½" / DN40	32	20	20		17	70	< 40	63	63		17	70
2" / DN50	46	5	5		5	10.35						
2" / DN50	46			0.05	1.24	2.28	< 40	13	52	90	7.2	15
3" / DN80	72	0.6	0.6		1	1.2						
3" / DN80	72			0.05	0.24	0.2	< 40	1	4	8	1.2	0.9

DP = differential pressure   GP = gauge pressure   AP = absolute pressure



## ORDERING MATRIX

Locate the order code for your specification and enter it into the appropriate box. See the Diaphragm Seals introduction for more information about each component.

\* For mounting options C & D, please use the universal Differential Pressure ordering matrix

MINIMUM  
Process Temperature

MAXIMUM  
Process Temperature

CERTIFICATES

0: None  
1: calibration test certificate  
2: conformity certificate  
3: material certificate  
4: NACE certificate

CONNECTION  
SIZE

A: 1"  
B: 1½"  
C: 2"  
D: 3"

MOUNTING OPTIONS\*

A: single direct  
B: single remote  
E: 1 direct, 1 barometric  
F: 1 remote, 1 barometric

FILL FLUID

1: TO - 02  
2: TO - 03  
3: TO - 11  
4: TO - 17  
5: TO - 23  
6: TO - 31  
7: TO - 41  
8: TO - 47

CAPILLARY  
LENGTH

0: None  
A: 1m  
B: 1.5m  
C: 2m  
D: 3m  
E: 4m  
F: 6m

CAPILLARY  
TYPE

0: None  
A: Seamless  
B: Armoured

CUSTOM  
LOGO

N: no  
Y: yes

QUANTITY

MODEL NO

1D



Can be fitted to **PG TR PS**

Select the instrument you want to have connected to this seal and write in the complete order number in the empty matrix above. Together with the seal order number this completes the specifications for your instrument.