

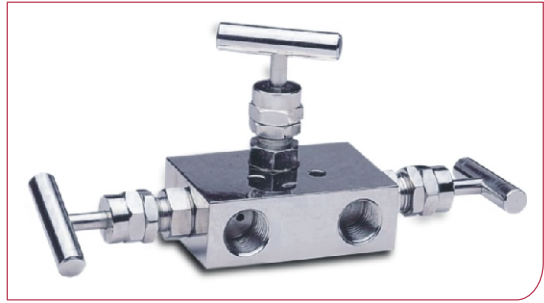

INSTRUMENT MANIFOLD VALVES

The PCi range of rugged instrument manifold valves are used for pressure isolation and equalisation, process draining, venting and flow control but are particularly used in the differential measurement of liquid, viscous and gaseous process systems.



Manifolds are constructed out of bar-stock and forged material in 316L stainless steel as standard, with Monel 400 and Hastelloy C276 as options. The valves are standard rated for pressures as high as 400bar at 100°C (6000 psi at 200°F) or 300bar at 275°C (4000 psi at 500°F) with PTFE packing. For higher temperatures Grafoil packing is used. Each manifold undergoes hydraulic pressure, pneumatic pressure, vacuum, vibration and thermal stability testing to ensure product integrity.

Standard models are available in 2-,3-,4- and 5-way configurations together with a full range of connection types; custom designs are available on demand.

STANDARD MANIFOLD FLOW CONFIGURATIONS

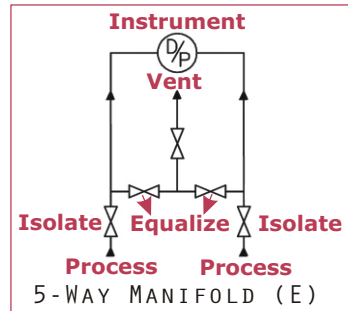
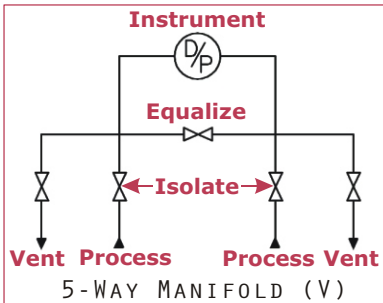
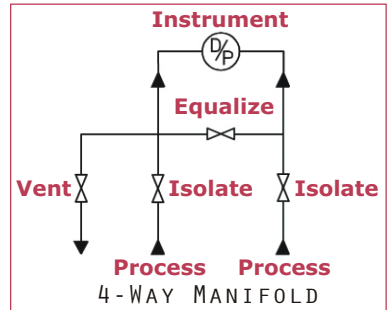
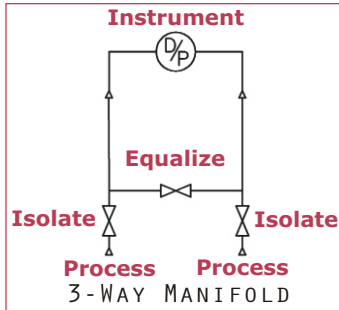
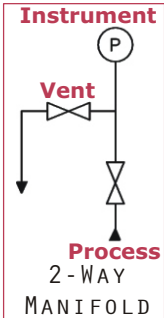

| Configuration | Code | No. Venting Bonnets | No. Isolation Bonnets | No. Equalising Bonnets | No. Inlets | No. Outlets | Pressure Ref. |
|---------------|------|---------------------|-----------------------|------------------------|------------|-------------|---------------|
| 2-way | 2 | 1 | 1 | 0 | 1 | 1 | Gauge / Abs |
| 3-way | 3 | 0 | 2 | 1 | 2 | 2 | Differential |
| 4-way | 4 | 1 | 2 | 1 | 2 | 2 | Differential |
| 5-way | 5e | 1 | 2 | 2 | 2 | 2 | Differential |
| 5-way | 5v | 2 | 2 | 1 | 2 | 2 | Differential |





INSTRUMENT MANIFOLD VALVES

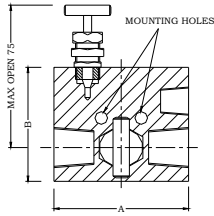

2-WAY

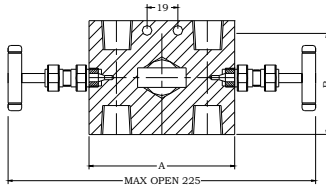

3-WAY

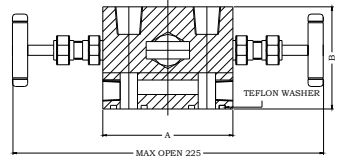

3-WAY (with flange)

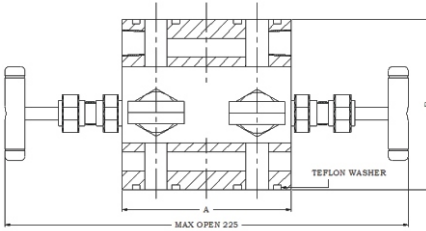

4-WAY

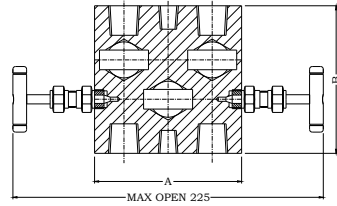

5-WAY

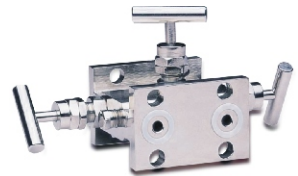
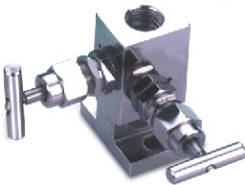

ORDERING MATRIX ~ M

CONFIGURATION

- 2
- 3
- 4
- 5E
- 5V

INLET CONNECTIONS

- 1: Flanged
- 2: Threaded

SIZE

- 4: 1/4"
- 8: 3/8"
- 2: 1/2"

STANDARD

- 1: BSP.P
- 2: NPT
- 3: BSP.T

UNION

- 1: Male
- 2: Female

CONSTRUCTION MATERIAL

- 6: 316L St. Steel
- MN: Monel 400
- HS: Hastelloy C276

MAX. PROCESS TEMPERATURE

PROCESS PRESSURE

OUTLET CONNECTIONS

- 1: Flanged
- 2: Threaded

SIZE

- 4: 1/4"
- 8: 3/8"
- 2: 1/2"

STANDARD

- 1: BSP.P
- 2: NPT
- 3: BSP.T

UNION

- 1: Male
- 2: Female

QUANTITY

MODEL NO.



Locate the order code for your specification and enter it into the appropriate box.

See above for more details.